



KONICA MINOLTA

bizhub C25

- ✓ Colour A4 multifunctional
- ✓ Up to 24 pages per minute

Functionality



Copying

- Colour
- Black & white



Printing

- Colour
- Black & white
- PCL/PS
- Local/Network
- USB



Scanning

- Colour
- Scan-to-eMail
- Scan-to-SMB
- Scan-to-FTP
- Scan-to-USB
- TWAIN Network
- WIA Scan



Faxing

- Super G3 Fax
- PC-Fax



Technology

EMPERON™	SIMITRI® HD TONER	IWS	OPEN API	i-OPTION	CSRC
✓	✓	✗	✗	✗	✓

Option diagram

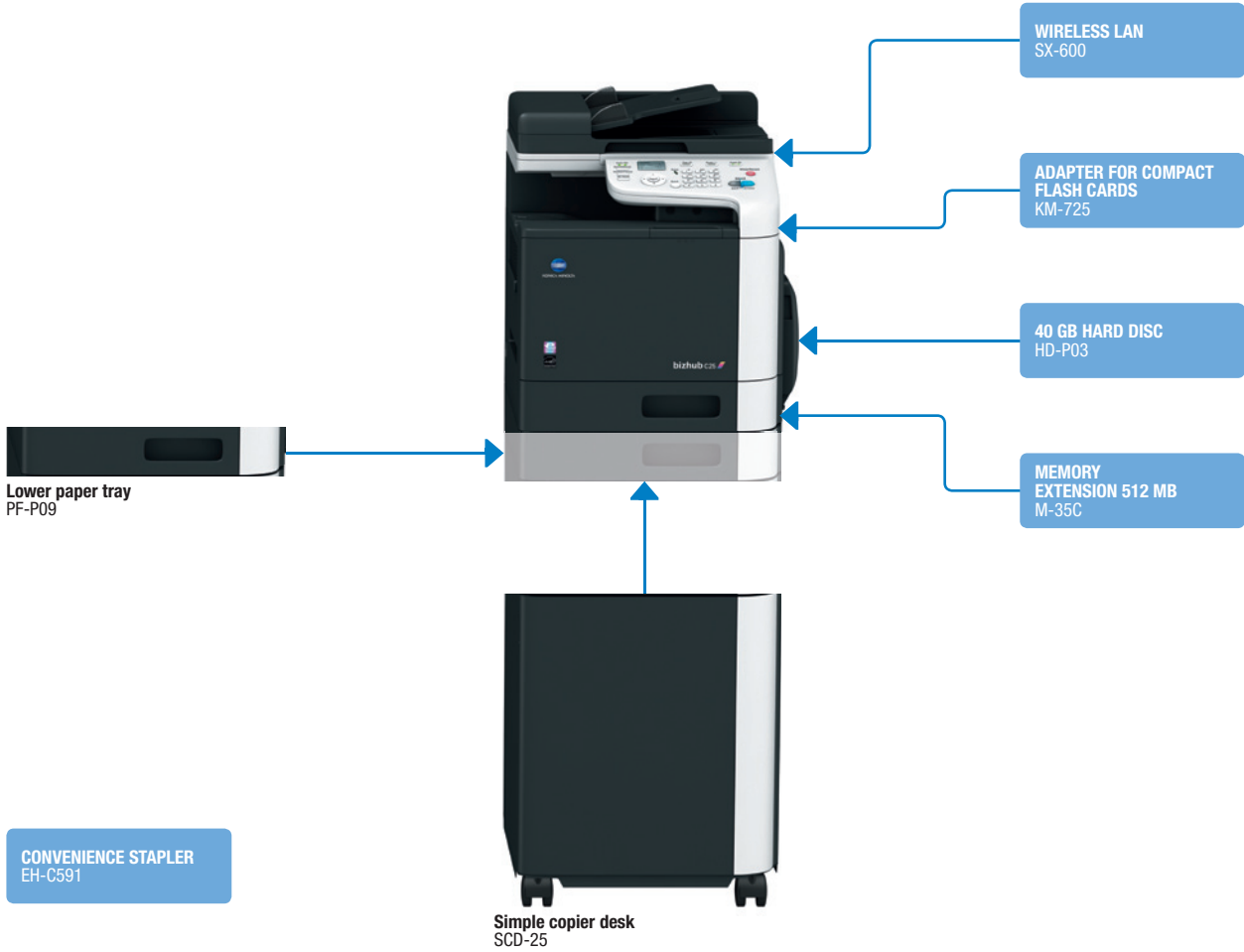

Finishing



Duplex

Descriptions

bizhub C25	A4 communication center with 24 ppm b/w and colour. Standard Emperon controller with PCL 6 and PostScript 3 support (XPS optional). Paper capacity of 250 + 100 sheets standard and 500 sheets optional. Automatic document feeder and duplex unit standard. Up to 768 MB memory (256 MB standard) and optional 40 GB hard disc.
PF-P09 Lower paper tray	A4, 500 sheets, up to 90 gsm
SCD-25 simple copier desk	Ensures ergonomic height and provides storage space for print media, etc.

KM-725 Flash card adaptor	Required for direct printing, downloading of fonts/profiles/overlays, collating
HD-P03 40GB Hard disc kit	40 GB hard disc; enables XPS and job retention in addition to all extra functions with CF card
M-35C Memory extension 512 MB	Memory extension for faster processing
SX-600 Wireless LAN	Wireless LAN to network connector
EH-C591 Convenience stapler	Convenient stapling of up to 50 prints per set

Technical specifications

COPIER SPECIFICATIONS

Copying process	Electrostatic laser copy Tandem, indirect
Toner system	Simitri® HD polymerised toner
Copy/print speed A4 (mono/colour)	Up to 24 ppm
Autoduplex speed A4 (mono/colour)	Up to 24 ppm
1st print out time (mono/colour)	11 sec. 16 sec.
Warm-up time	Approx. 38 sec. ³
Copy resolution	600 x 600 dpi
Gradation	256 gradations
Multi-copy	1–99
Original format	Max. A4
Magnification	25–400% in 0.1% steps
Copy functions	Duplex copy; 2in1, 4in1; density adjustment; card shot; electronic collation ¹

PRINTER SPECIFICATIONS

Print resolution	600 x 600 dpi x 3 bit
1st print out time (mono/colour)	16 sec.
Controller CPU	800 MHz
Page description language	PostScript 3 (CPSI 3016) PCL 6 (XL 3.0) PCL 5e/c XPS ² PDF 1.7 Direct Printing ¹
Operating systems	Windows XP (32/64) Windows VISTA (32/64) Windows 7 (32/64) Windows Server 2003 (32/64) Windows Server 2008 (32/64) Windows DPWS support Macintosh OS X (10.2.8/10.3.9/10.4/10.5/10.6) Linux: SUSE; Red Hat Citrix Netware 4/5/6
Printer fonts	80 x PCL Latin 137 x PostScript 3 Emulation Latin
Print functions	Direct print ¹ of PDF (version 1.7); JPEG; TIFF; XPS ² ; overlay; watermark; n-up; poster; booklet page order; collating ¹

SCANNER SPECIFICATIONS

Scan speed (mono/colour)	Up to 18/8 opm
Scan resolution	Max.: 600 x 600 dpi (TWAIN/WIA only)
Scan modes	Scan-to-eMail Scan-to-SMB Scan-to-FTP Scan-to-USB TWAIN Network WIA Scan
File formats	JPEG; TIFF; PDF
Scan destinations	Up to 220 (shared with fax)

FAX SPECIFICATIONS

Fax standard	Super G3
Fax transmission	Analogue; PC-Fax
Fax resolution	Max.: 203 x 392 dpi (super fine)
Fax compression	MH; MR; MMR; JBIG
Fax modem	Up to 33.6 Kbps
Fax destinations	Up to 220 (shared with scan)
Fax functions	Time shift; fax forwarding to e-mail



SYSTEM SPECIFICATIONS

System memory	Standard: 256 MB Max.: 768 MB
System hard disc²	40 GB optional
CF card adapter¹	Optional
Interface	10Base-T/100Base-TX/1000Base-T Ethernet USB 2.0
Network protocols	TCP/IP (IPv4 / IPv6); IPX/SPX; NetBEUI; AppleTalk (EtherTalk); SMB; LPD; IPP; SNMP; HTTP; HTTPS
Frame types	Ethernet 802.2; Ethernet 802.3; Ethernet II; Ethernet SNAP
Automatic document feeder	Up to 35 originals; A4; 50–110 gsm
Printable paper size	A6–A4; customised paper sizes
Printable paper weight	60–210 gsm
Paper input capacity	Standard: 350 sheets Max.: 850 sheets
Tray 1	250 sheets; A6–A4; 60–210 gsm Custom (92–216 x 148–297 mm)
Tray 2 (optional)	500 sheets; A4; 60–90 gsm
Manual bypass	100 sheets; A6–A4; 60–210 gsm Custom (92–216 x 148–356 mm)
Automatic duplexing	A4; 60–210gsm
Output capacity	Max.: 150 sheets face down
Copy/print volume (monthly)	Rec.: 1,260 pages Max.: 120,000 pages
Toner lifetime⁴	Black/CMY yield up to 6,000 pages
Imaging unit lifetime	Black/CMY yield up to 30,000 pages
Power consumption	220–240 V/50/60Hz; less than 1.1 KW
System dimensions (W x D x H)	447 x 558 x 490 mm
System weight	Approx. 32.5 kg

- All specifications refer to A4-size paper of 80 gsm quality.
- The support and availability of the listed specifications and functionalities varies depending on operating systems, applications and network protocols as well as network and system configurations.
- The stated life expectancy of each consumable is based on specific operating conditions such as page coverage for a particular page size (5% coverage of A4). The actual life of each consumable will vary depending on use and other printing variables including page coverage, page size, media type, continuous or intermittent printing, ambient temperature and humidity.
- Some of the product illustrations contain optional accessories.
- Specifications and accessories are based on the information available at the time of printing and are subject to change without notice.
- Konica Minolta does not warrant that any specifications mentioned will be error-free.
- All brand and product names may be registered trademarks or trademarks of their respective holders and are hereby acknowledged.

SYSTEM FEATURES

Security	IP filtering and port blocking SSL2, SSL3 and TLS1.0 network communication IPsec support IEEE 802.1x support Secure Print ² Hard disc data encryption (print only) ²
Software	PageScope Net Care Device Manger PageScope Direct Print PageScope WebConnection

- ¹ Optional CF card enables direct printing (PDF, TIFF, JPEG), downloading fonts/profiles/overlays, collating.
- ² Optional hard disc kit enables secure printing, proof-then-print, print & hold, job storing, XPS emulation and using downloaded profiles in addition to all extra functions with CF card.
- ³ Warm up time may vary depending on the operating environment and usage
- ⁴ Declared yield in accordance with ISO/IEC 19798

